

WHITLEY MANUFACTURING



FOR: Wayne State University

TYPE: Press Box

WITH: Innovative Modular Sol.

Wayne State University is a major institution of higher education in the Detroit area. It is Michigan's only urban public research university. They have a growing athletics department with a variety of programs to serve the rapidly expanding student population.

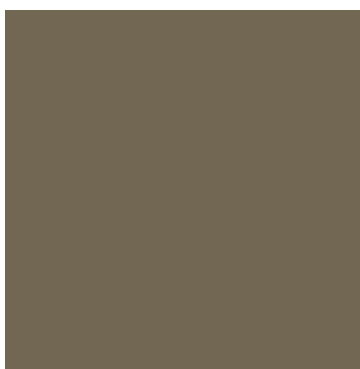



WHITLEY ATHLETICS

- Press boxes
- Ticket booths
- Concessions buildings
- Restroom facilities
- Shower / locker

THEIR NEED

Wayne State's grandstand was built in the late 1960s, as was their press box. The press box was deemed temporary until the late 1990s when strong winds and accumulating age turned temporary into unusable. With a growing athletics program, the school wanted a facility that would reflect positively on their programs, building pride in students and presenting a strong face to recruits. The school obtained bids for a site-built structure and immediately suffered "sticker shock".

OUR SOLUTION

By chance, Wayne State requested a bid from an architectural firm that was familiar with modular, prefabricated commercial structures. The prefab price was within the school's budget, so the project proceeded. And it went forward quickly: from the first support beams going up to the ribbon cutting ceremony - a mere two weeks passed. The two-story building features almost 1,600 sq. ft. of space with a Presidential suite, ample room for the press, areas for opposing coaches, and rooms for cameramen and scoreboard operators.

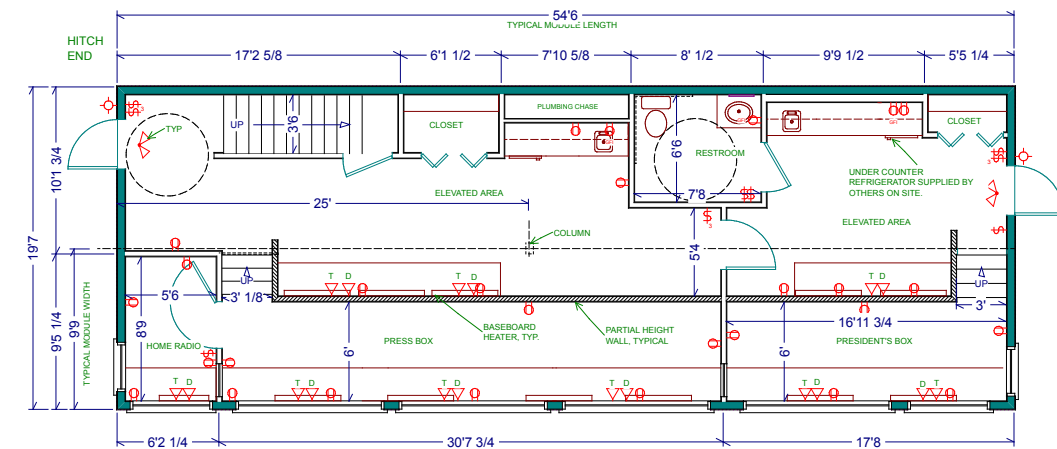
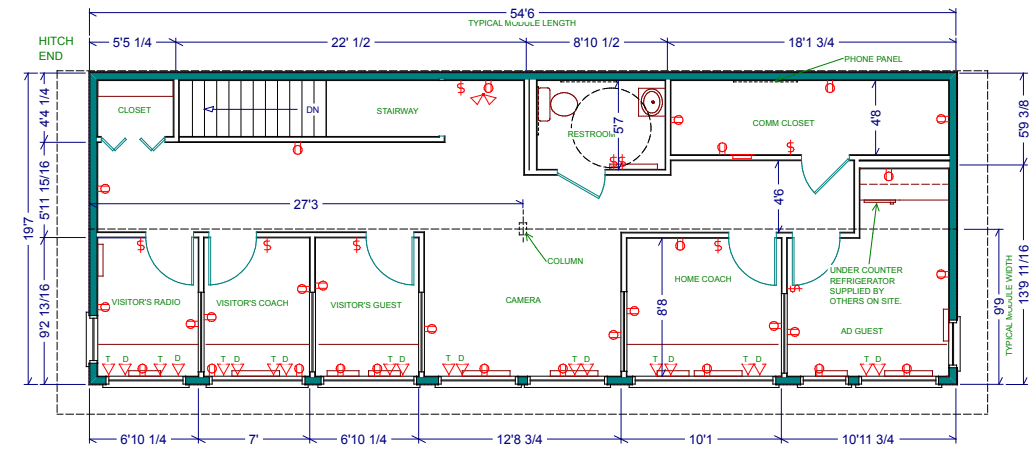

ATHLETICS

Whitley Mfg. Co., Inc.
 201 W. First St.
 So. Whitley, IN 46787
 (260) 723-5131
 www.whitleyman.com

- South Whitley, IN
- Rochester, IN
- Marysville, WA