



ST. XAVIER COLLEGE 3D ARTS STUDIO



Location Chicago, IL

Partners Innovative Modular Solutions
Newman Architecture

Type 3D Arts Studio

Size Total: 1,600 square feet (nom)

Units 2

Client St. Xavier College in University in Chicago, IL is an independent, Catholic, comprehensive University offering Bachelor's + Master's degrees to over 5,000 students.

Their Need The University required a specialized building to provide additional space for their arts programs. In particular, space was needed for their three dimensional arts program.

The project was designed by Newman Architecture of Naperville, IL. The project had been put out to bid as a conventional construction project, but bids had all been returned over-budget.

Our Solution The architecture firm approached Whitley and IMS to provide a structure on-budget and on an accelerated timeline.

The building needed to blend a modern design aesthetic with materials that complemented the existing buildings on campus. By constructing the balance of the building off-site, disruption to the campus was minimized and student safety preserved. Specialized air handling was also required to maintain a healthy indoor environment as art projects took place.



Construction begins off-site on the 1,600 SFT building.

Modular building is delivered to the site and final finish is applied.

The building features modern fiber cement paneling in a variety of finishes.

The building is constructed to meet or exceed all applicable commercial construction codes, providing a permanent solution.

By building off-site, the project could largely be completed without disrupting the campus and hindering the quality of education provided.

PROJECT START.

PROJECT FINISH.

AESTHETICS.

QUALITY.

FLEXIBILITY.

St. Xavier 3D Art Studio

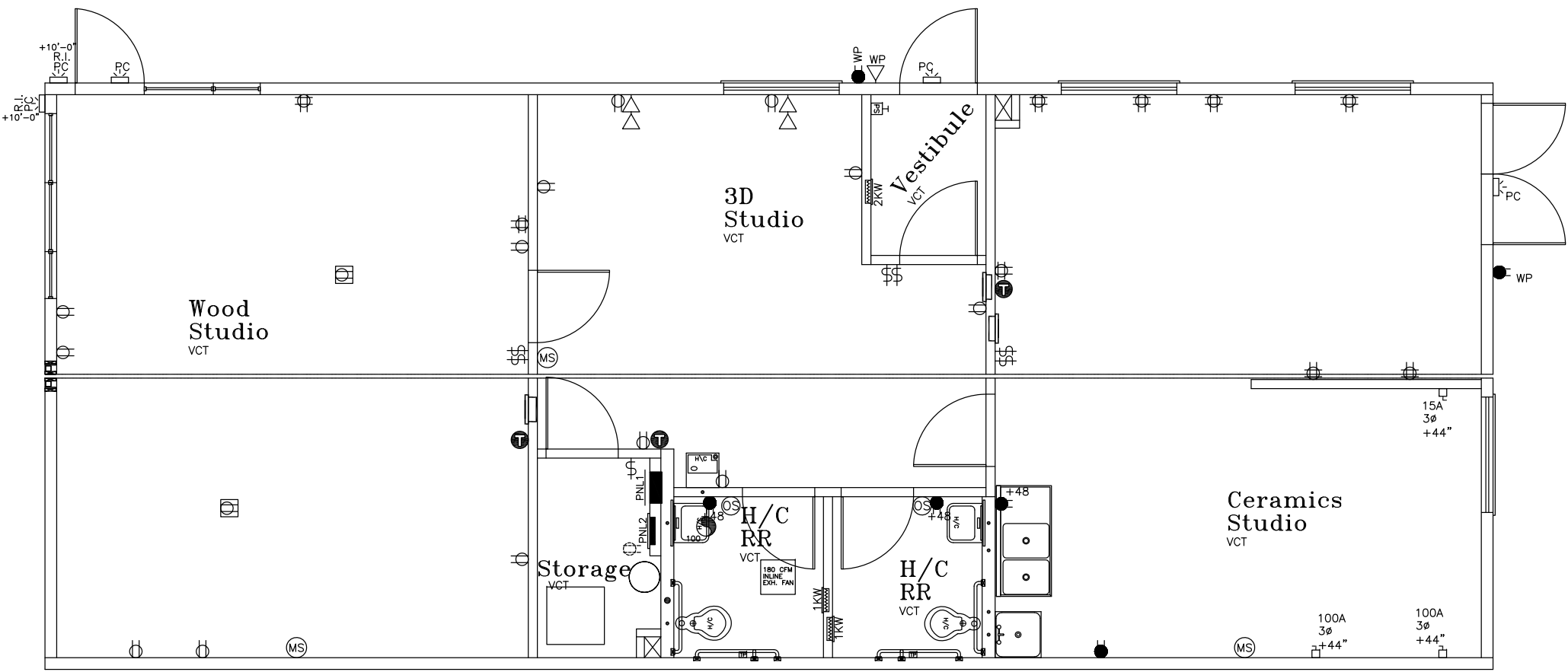

Whitley Mfg. Co., Inc.
 South Whitley, IN // Rochester, IN
 Marysville, WA
 (260) 723-5131
 www.whitleyman.com

FEATURES

Exterior covering is fiber cement paneling for a modern look.

Material finishes were also selected to complement the surrounding buildings.

A specialized HVAC system maintains air quality at the wood studio.

The building was designed as a permanent solution for the school.

The buildings were constructed off-site in a controlled environment, delivering a high-quality solution on an accelerated timeline with minimal site disruption.