



CASE STUDY

.....

KEY ACHIEVEMENTS

Finished with 2 1/2 times less waste when compared to traditional building.

50% faster than a conventional building schedule.

Steel framing consisted of 72% recycled material.

Environmentally friendly FSC lumber.

Minimal disruption to the school campus.

The City of Boston Public Schools requested a proposal from Triumph Modular for a complete turn-key construction and installation of a classroom addition to an existing structure. The building would be occupied by middle school students, each classroom to accommodate 28 students, utility rooms, office suite, corridor, foyer, associated restrooms and custom glass connecting corridor. The addition needed to fit seamlessly with the façade of the existing structure.

SCHOOL OPENS ON TIME FOR DENNIS HALEY

.....

The exterior finishes of custom fiber cement and specialized trim matches the color and design of the existing facility. A new fully enclosed custom glass connecting foyer and corridor was added between the existing facility and new construction. Exterior ramps with deck and handrails are constructed in accordance with the ADA and Massachusetts Architectural Board. Modular construction was selected as the ideal solution to complete this project on schedule with minimal disruption to the existing school campus. And before the scheduled start date arrived, the city was proud to welcome their students back to their new facility.

DENNIS HALEY SCHOOL, CLASS ROOM ADDITION

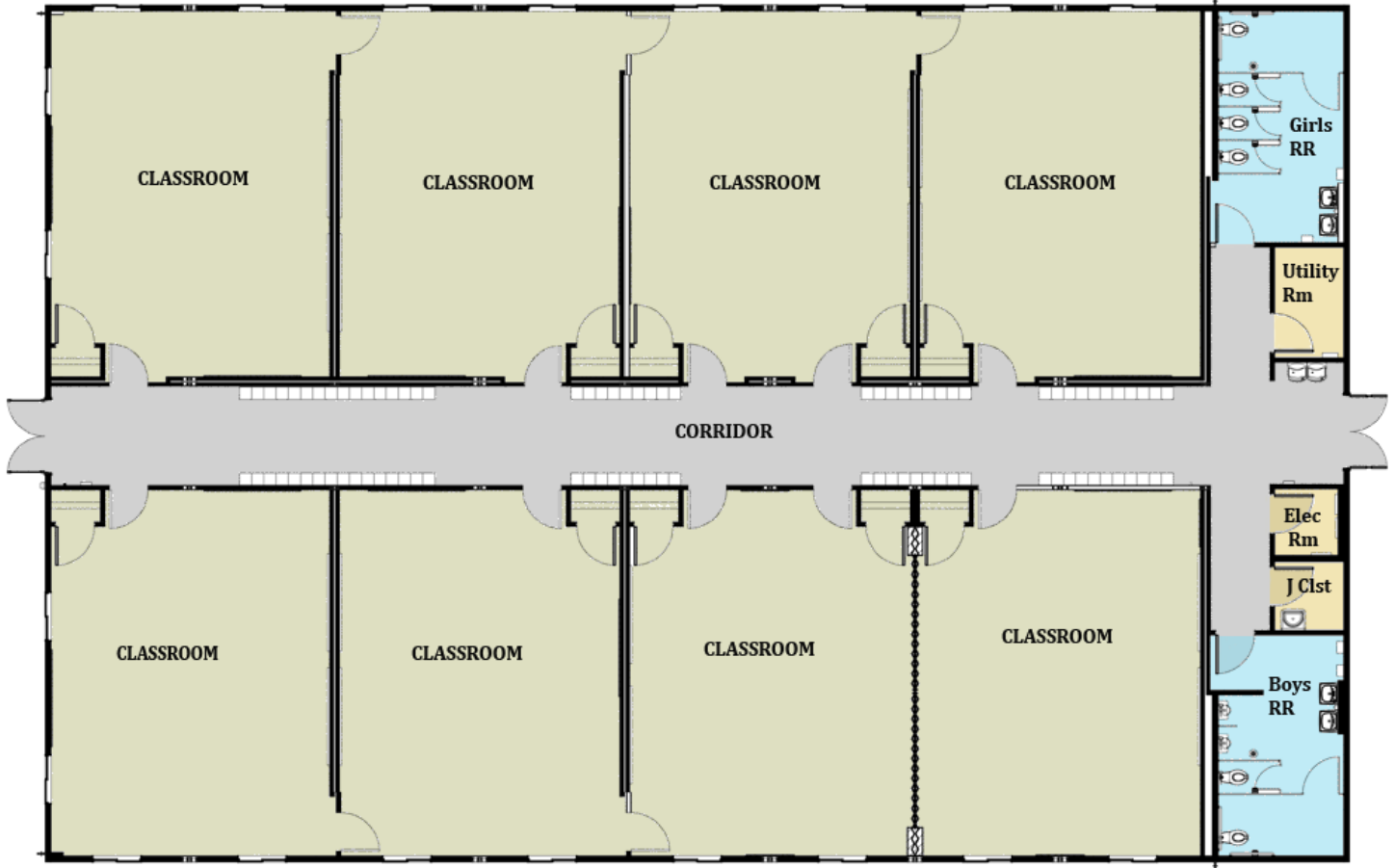

KEY FACTS

LOCATION

ROSLINDALE, MA

PARTNERS

TRIUMPH MODULAR

TYPE

RELOCATABLE CLASSROOM
ADDITION

SIZE

7,979 SQUARE FEET

UNITS

18 MODULES

