



# CASE STUDY

---

*Winthrop University Hospital was planning the addition of a Level One Trauma Center to treat both children and adult trauma patients. Because of the building site's proximity to the emergency center, disruption to its essential services would had to be addressed.*

## WINTHROP HOSPITAL TRAUMA CENTER ADDITION

---

### KEY ACHIEVEMENTS

*All units set in one day.*

*Completed project in approximately 10 weeks.*

*Off-site construction eliminated disruption to essential services.*

*2 1/2 Times less waste when compared to traditional building.*

*Less environmental impact.*

*Flexible design for new and existing markets.*

Winthrop University Hospital chose to utilize modular construction and turned to Innovative Modular Solutions (IMS) for assistance. Forming an alliance with Whitley Manufacturing, the eleven module building was constructed off-site. The 3400 square foot building consisted of an ambulance driver's area, emergency decontamination shower, holding areas, nurse's stations and three (3) Level One Trauma bays. The building's exterior décor was a precise match with the existing buildings, giving a seamless appearance.

Whitley Manufacturing's off-site construction was the perfect solution to eliminate disruption to emergency personnel and maintain normal operations. By keeping the majority of all construction away from the hospital campus, the chance of contamination was also eliminated. And once the units were delivered, the IMS set-crew had all 11 units installed in one day, dramatically reducing the total construction time.

# Winthrop Hospital Trauma Center

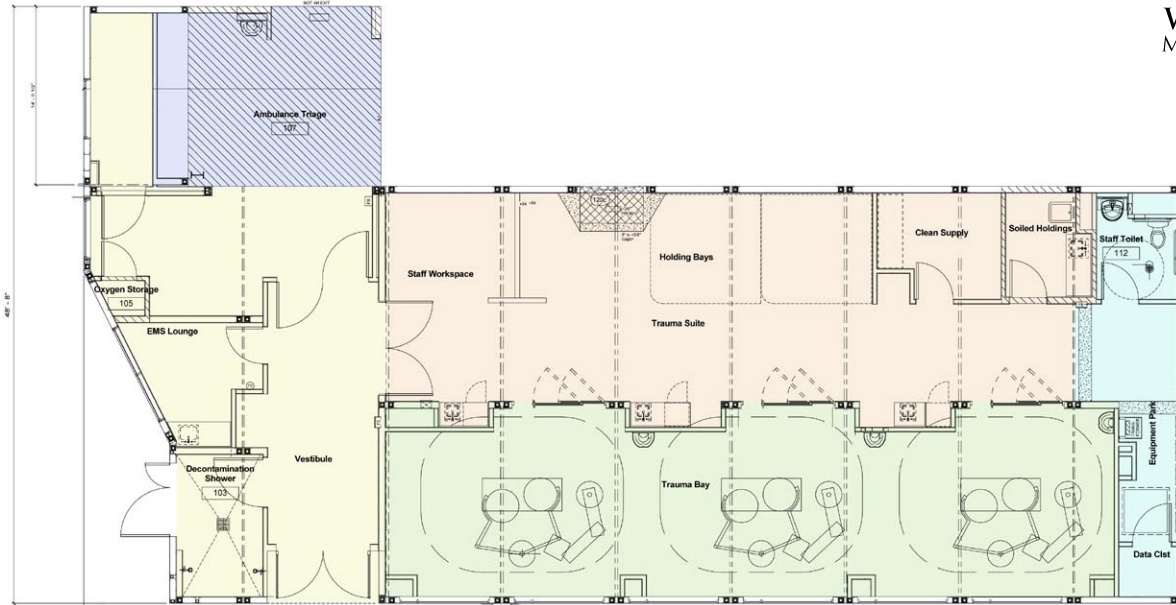

Trauma Bay



Trauma Suite

## KEY FACTS

### PROJECT NAME

WINTHROP HOSPITAL TRAUMA CENTER

### LOCATION

MINEOLA, NY

### PARTNERS

INNOVATIVE MODULAR SOLUTIONS

### PROJECT TYPE

HOSPITAL ADDITION

### BUILDING SIZE:

3400 SQ. FT.

### BUILDING UNITS:

11 MODULES



Serving you nationwide from South Whitley, IN (260) 723-5131 • Rochester, IN (574) 223-4934 • Marysville, WA (360) 653-5790  
& Leola, PA (717) 656-2081 • Visit us online at [www.whitleyman.com](http://www.whitleyman.com)