

clearspanthree

DESIGNED FOR:

- OFFICE USE
- EDUCATION / CLASSROOMS
- DAYCARE / CHILD DEVELOPMENT

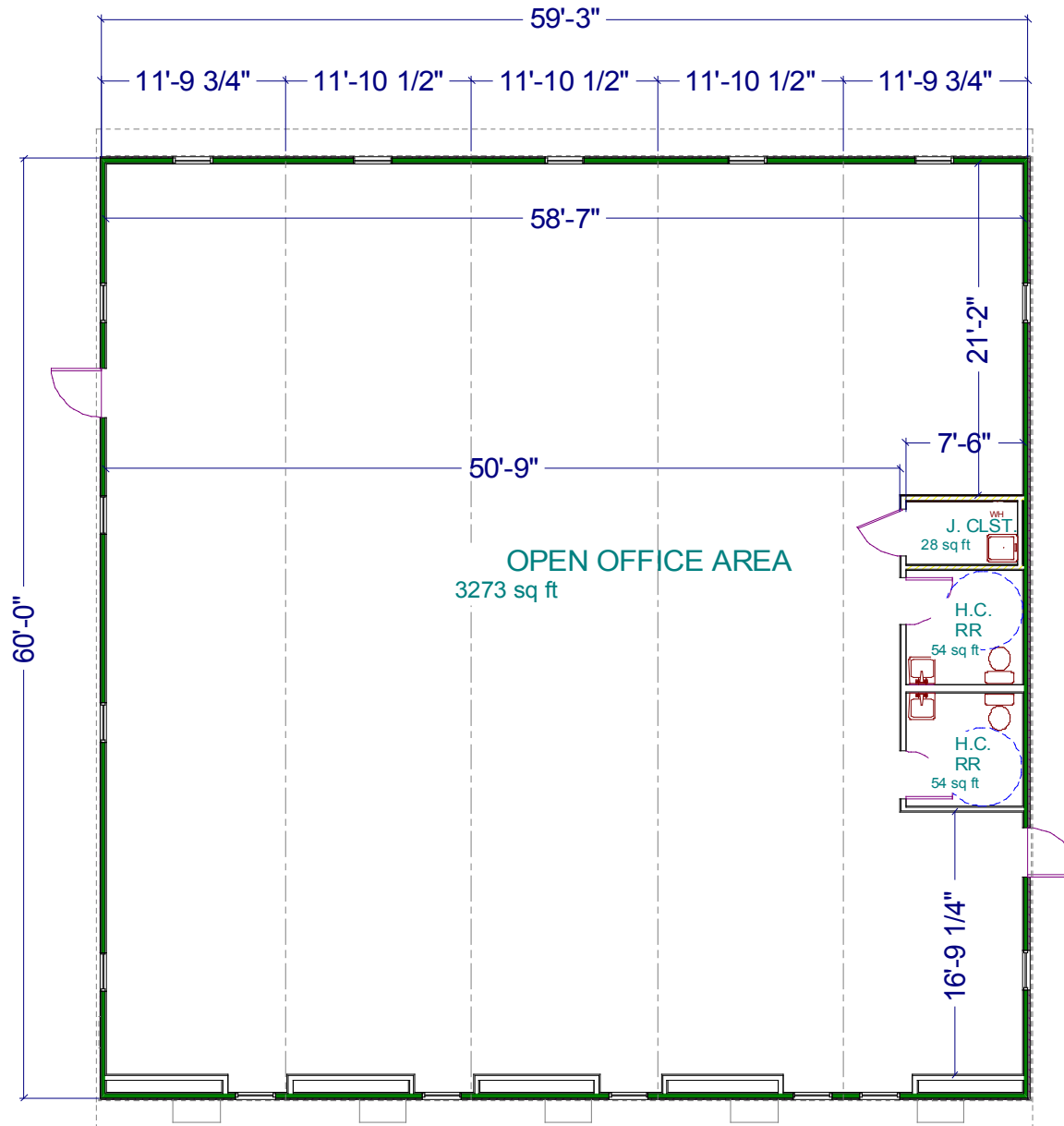

Whitley Mfg. Co., Inc.
South Whitley, IN // Rochester, IN
Marysville, WA
(260) 723-5131
www.whitleyman.com

clearspanthree



Sample Exterior. Refer to Plan for Building Size & Layout.

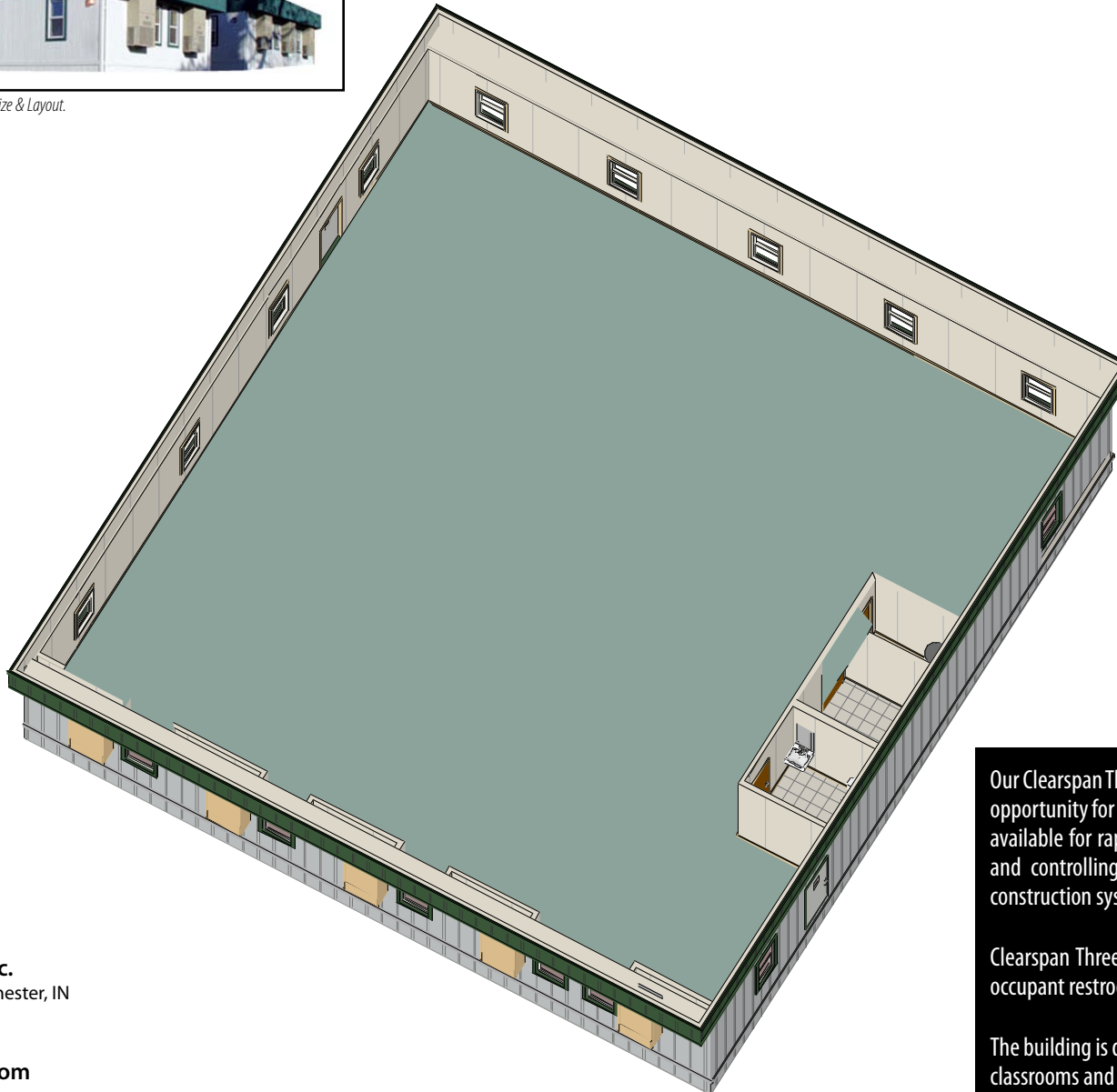

DESIGNED FOR:

- OFFICE USE
- EDUCATION / CLASSROOMS
- DAYCARE / CHILD DEVELOPMENT



Whitley Mfg. Co., Inc.
South Whitley, IN // Rochester, IN
Marysville, WA
(260) 723-5131
www.whitleyman.com

Our Clearspan Three design offers the flexibility of open space and the opportunity for a custom building layout. Our Clearspan buildings are available for rapid delivery, helping you adapt to changing markets and controlling construction costs with our economical modular construction system.

Clearspan Three features 3,273 sq. ft. of open space, 2 ADA single-occupant restrooms and a Janitor's closet.

The building is designed for use as office space, education / training / classrooms and daycare / child development.