



CASE STUDY

KEY ACHIEVEMENTS

6 modules

5,440 sq ft

Fully plumbed for Bicarb & Reverse Osmosis

Completed in 100 days

12 treatment chairs

Natural sun in treatment area

DaVita provides dialysis services for those diagnosed with chronic kidney failure, nearly 54,000 patients, in 37 states from over 624 outpatient dialysis centers. They also provide acute inpatient dialysis services in over 369 hospitals across the country. They are the largest independent provider of dialysis services in the US.

DAVITA - LA PLACE, LA.

Helping recover from Katrina

When Hurricane Katrina rumbled through the Gulf States, one of its victims was a dialysis clinic in La Place, Louisiana, just northwest of downtown New Orleans. DaVita wanted to recover rapidly and they wanted a building that would not be simply a stop-gap structure.

DaVita turned to our distributor, MedBuild, an expert in medical facilities, who chose Whitley. The customer cited two reasons: speed and trust. They knew the building would arrive quickly and take very little time to finish, once on site. They also trusted Whitley and MedBuild after the recent successful completion of another dialysis clinic in Kentucky. Whitley began construction in November and shipped the building in early December. The foundation was poured while the completed building was en route southward from Indiana. The modules were quickly crane set, finished and connected to utilities. From order to opening was

DAVITA - LaPlace, LA.

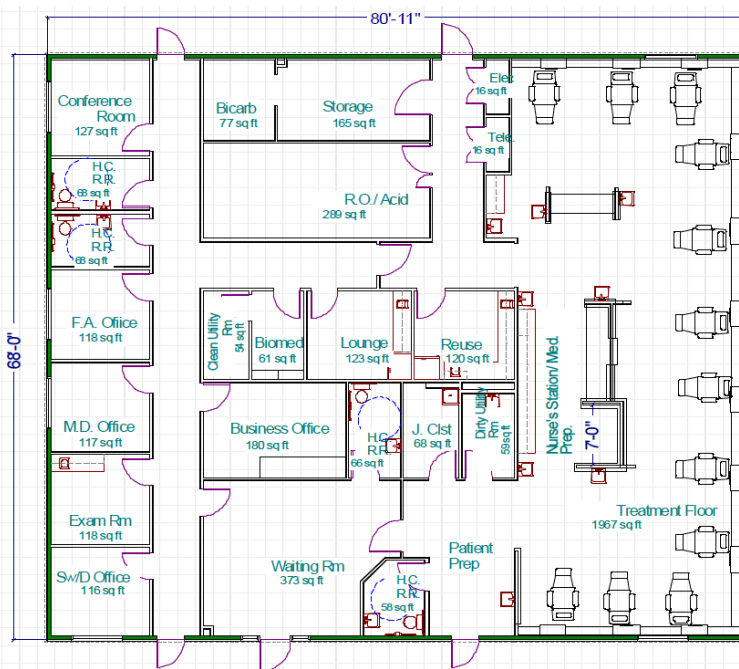

KEY FACTS

PROJECT NAME
DAVITA - LAPLACE, LA.

DEVELOPER
MEDBUILD

PROJECT TYPE
DIALYSIS CLINIC

BUILDING SIZE:
5,440 SQ. FT.

