

DIALYSIS STATIONS	OFFICES	RESTROOMS	SPECIAL FACILITIES	SQ. FOOTAGE <i>appx.</i>
12	4	4	Bicarbonate Rm • R.O. Rm • Biomed Rm •	5,400



BUILDINGS FOR THE MEDICAL FIELD

BY WHITLEY MANUFACTURING

- **Medical.** Flexible, efficient clinic and office space for the medical field.
- **Dental.** Flexible, efficient space for a dental practice.
- **Imaging.** The latest in M.R.I. technology in a fraction of the time and with the flexibility of modular.
- **Dialysis.** Renal treatment facilities with the flexibility and value of Whitley Mfg. Medical Bldgs.



www.whitleyman.com

Treatment Rm

- Spacious treatment room allows you to serve many patients.
- The nurse's station assures that medical staff is always in contact with patients.

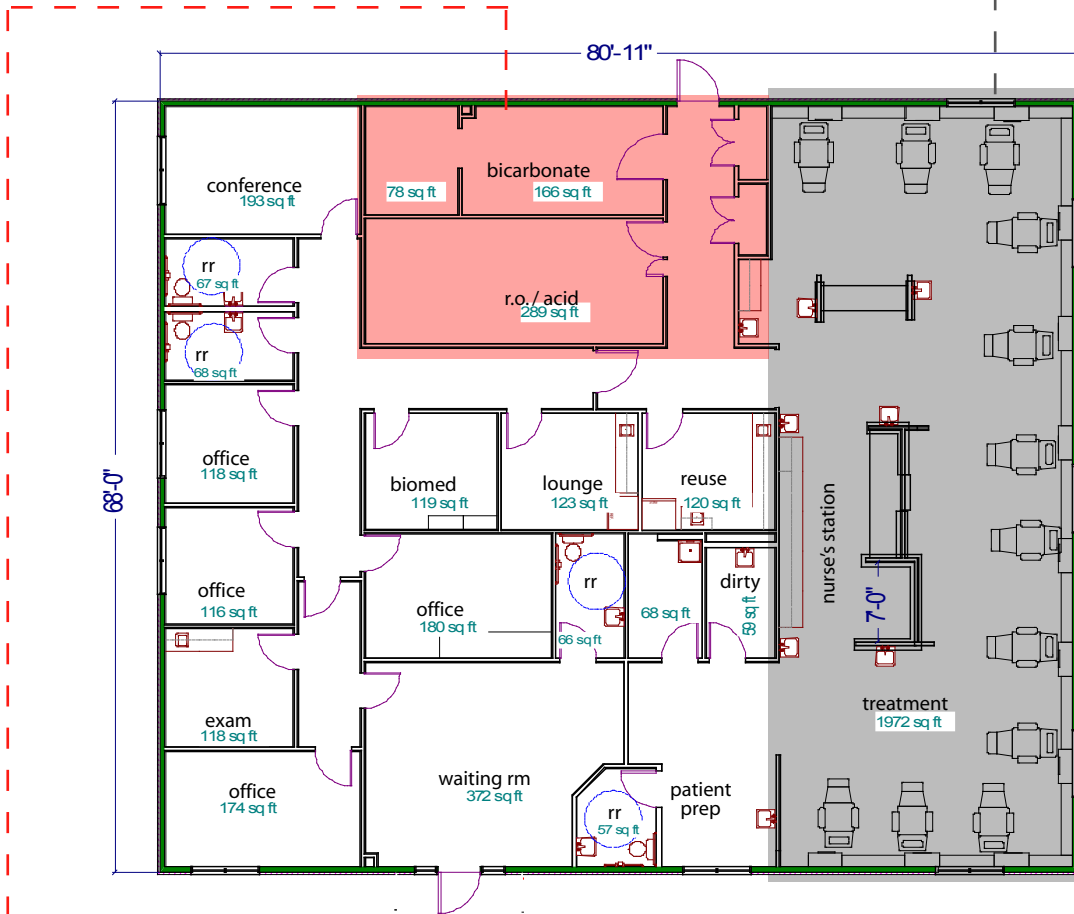

The photograph shown above is one of many different aesthetic styles available for the **Dialysis One** Medical Building. Finishes and amenities will be custom selected to complement your individual project.

Special Facilities

- Whitley Manufacturing has the experience and expertise to design and build DIALYSpace with the latest in technology for renal treatment.
- DIALYSpace features a thoroughly engineered plumbing system.
- Building features rooms for R.O. . Acid, as well as Bicarbonate and Biomed storage.

Whitley Mfg. Co. Inc.

- South Whitley, Indiana
 - Rochester, Indiana
 - Marysville, Washington
- (260) 723-5131

www.whitleyman.com